

2009 RIVA 63' VERTIGO – M/Y NESMARI



MAIN YACHT CHARACTERISTICS:

Boat Name:	NESMARI	Year:	2009
Builder/Make:	Riva	Model:	63' Vertigo
Hull Number:	26	Type:	Motor Yacht
Length Overall:	64ft 2in 19.57m	Beam:	15ft 9in 4.80m
		Draft:	5ft 3in 1.60m
Engine Make/Model:	2x MAN V12-1360	Engine horsepower:	2x 1360hp
Propulsion Type:	V Drive	Fuel Type:	Diesel
Cruising Speed:	34 knots	Max Speed:	40 knots
Engine Hours:	1728	Range:	270 nautical miles
Guest Cabins:	3	Crew Cabins:	1
Total Guests:	6	Total Crew:	1
Total Guest Toilets:	3	Crew Toilets:	1
On Display:	Marbella	Country:	Spain
Flag:	Spanish	Private/Commercial:	Private
Asking Price:	€ 925,000	Tax Status:	VAT Paid

Disclaimer:

Brokers present the particulars of this Vessel in good faith; however, they cannot guarantee or warrant the accuracy of this information, nor do they provide any assurances regarding the Vessel's condition. Images of the Vessel may be sourced from a catalogue. This document shall not, under any circumstances, be deemed a contractual term.

2009 RIVA 63' VERTIGO – M/Y NESMARI

TECHNICAL CHARACTERISTICS:

RCD / CE Category:	A - Ocean	Classifying Body:	RINA
Main Generator:	Kohler 13kW 50Hz	2nd Generator:	/
Hours:	3300	Hours:	/
Fuel Tank:	3200 lt 845 gal	Water Tank:	660 lt 174 gal
Black Tank:	330 lt 87 gal	Grey Tank:	330 lt 87 gal
Stabiliser(s):	Trim tabs system	Bow thruster:	Yes
Stern thruster:	Yes (Sidepower)	Air conditioning:	Yes

YACHT DESCRIPTION:

Architect:	Officina Italiana Design	Material:	GRP
Internal Furniture:	High-gloss cherry wood	External Hull Colour:	Metallic Silver

M/Y NESMARI is a Riva 63' Vertigo that captures the essence of the model—sleek, fast and unmistakably elegant. Finished in a custom metallic silver hull, she presents a more contemporary look while retaining the timeless Riva character. Powered by twin MAN engines, she delivers strong performance with a comfortable cruising profile. Maintained with care by a full-time crew, she benefits from updated navigation electronics in 2022 and a specification that supports easy, enjoyable use. The hard top with extended aft section enhances onboard living, making her a versatile and well-rounded yacht for Mediterranean cruising.

LAYOUT:

The layout is practical and well balanced, offering comfortable accommodation for six guests across three cabins. The full-beam master sits amidships, with a forward VIP cabin and a twin guest cabin, all with en-suite bathrooms. The main deck is centred around a bright saloon connected to the cockpit, creating a natural flow between interior and exterior spaces. The hard top provides shade and protection while maintaining an open feel. Circulation is simple and intuitive, with easy access to the bow sunbathing area and aft deck. A separate crew cabin ensures privacy and smooth day-to-day operation onboard.

BROKER COMMENTS:

M/Y NESMARI is a well-kept Vertigo with a strong spec and modern updates, offering a clean, straightforward opportunity in a segment where condition and usability make all the difference.

Disclaimer:

Brokers present the particulars of this Vessel in good faith; however, they cannot guarantee or warrant the accuracy of this information, nor do they provide any assurances regarding the Vessel's condition. Images of the Vessel may be sourced from a catalogue. This document shall not, under any circumstances, be deemed a contractual term.

2009 RIVA 63' VERTIGO – M/Y NESMARI

SPECIFICATION:

EQUIPMENT:

General:

Custom metallic silver hull finish
Full-time crew maintained

External:

Hard top with extended aft fibreglass section
Teak decking (cockpit, side decks, swim platform)
Hydraulic bathing platform
Hydraulic passerelle
Swim ladder
Cockpit wet bar with sink and ice maker

Internal:

Layout: 3 guest cabins with en-suite bathrooms
Crew cabin
Saloon with seating and dining area

Technical:

2 x MAN 1360 hp engines
Kohler generator
Air conditioning
Bow thruster
Stern thruster (Side Power, new 2022)
Trim tabs system (flaps)
Black water tank system
Fresh water WC system
Shore power with battery charger

NAVIGATION:

Raymarine HybridTouch displays (new 2022)
Raymarine autopilot p70Rs (new 2022)
Raymarine radar and GPS (new 2022)
Raymarine VHF with DSC (new 2022)
Loudhailer Standard Horizon (new 2022)
Tridata (speed, depth, wind)

AUDIO VISUAL:

40" TV in saloon
22" TV in master cabin
Bose sound system (3 zones: interior, bow, stern)
Hi-fi system in cabins

DOMESTIC:

Fridge / freezer
Ceramic cooker
Microwave oven
Dishwasher
Extractor hood

TENDER(S) & TOYS:

Williams 325 Turbojet
Garage with hydraulic opening and winch

Disclaimer:

Brokers present the particulars of this Vessel in good faith; however, they cannot guarantee or warrant the accuracy of this information, nor do they provide any assurances regarding the Vessel's condition. Images of the Vessel may be sourced from a catalogue. This document shall not, under any circumstances, be deemed a contractual term.

2009 RIVA 63' VERTIGO – M/Y NESMARI

LAYOUT:

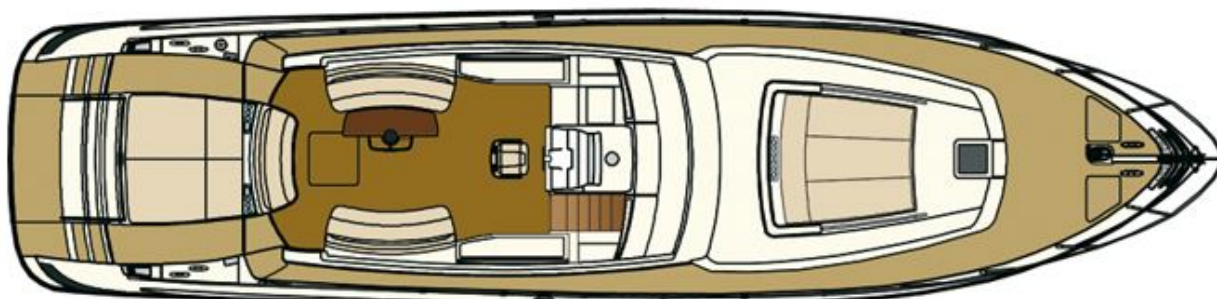
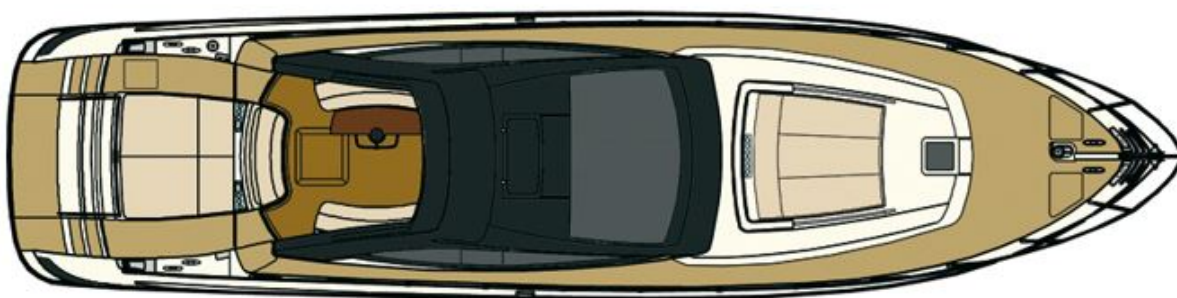

Disclaimer:

Brokers present the particulars of this Vessel in good faith; however, they cannot guarantee or warrant the accuracy of this information, nor do they provide any assurances regarding the Vessel's condition. Images of the Vessel may be sourced from a catalogue. This document shall not, under any circumstances, be deemed a contractual term.

2009 RIVA 63' VERTIGO – M/Y NESMARI

LAYOUT (continued):

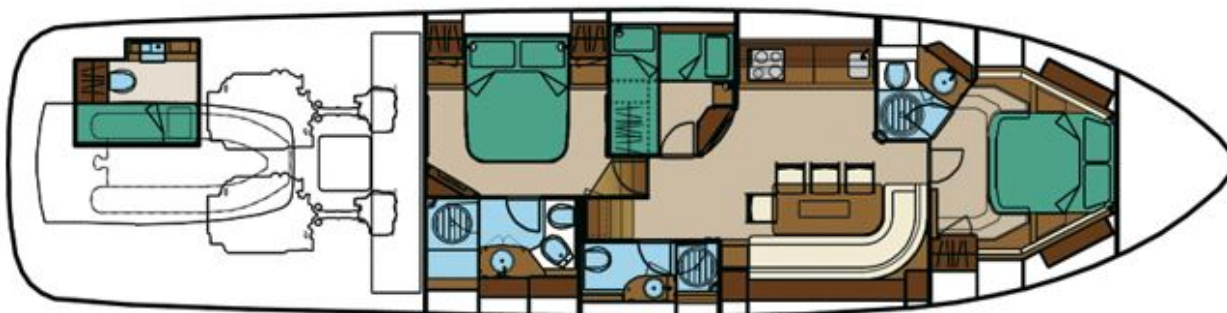

Disclaimer:

Brokers present the particulars of this Vessel in good faith; however, they cannot guarantee or warrant the accuracy of this information, nor do they provide any assurances regarding the Vessel's condition. Images of the Vessel may be sourced from a catalogue. This document shall not, under any circumstances, be deemed a contractual term.