

2024 Custom Line Navetta 30 - M/Y AT ONE



MAIN YACHT CHARACTERISTICS

Boat Name: M/Y AT ONE

Builder/Make: Custom Line

Hull Number: #19

Length Overall: 28.43m / 93.3ft

Hull Length: 23.98m / 78.8ft

Waterline Length: 23.91m / 78.5ft

Engine Make/Model: 2x MAN V8 1000

Propulsion Type: Shaft Drive

Cruising Speed: 13 knots

Engine Hours: 615 (Port) / 615 (Starboard)

Guest Cabins: 5

Total Guests: 10

Total Guest Toilets: 6

On Display: Pisa

Flag: Malta

Asking Price: € 9,600,000

Year: 2024

Model: Navetta 30

Type: Semi-Displacement

Beam: 7.31m / 24ft

Draft: 2.20m / 7.3ft

Gross Tonnage: <200 GT

Engine horsepower: 2x 1000hp

Fuel Type: Diesel

Max Speed: 14.5 knots

Range at CS: 850nm

Crew Cabins: 3

Total Crew: 5

Crew Toilets: 3

Country: Italy

Private/Commercial: Commercially registered (MCA)

Tax Status: Not Paid

Disclaimer:

Brokers present the particulars of this Vessel in good faith; however, they cannot guarantee or warrant the accuracy of this information, nor do they provide any assurances regarding the Vessel's condition. Images of the Vessel may be sourced from a catalogue. This document shall not, under any circumstances, be deemed a contractual term.

2024 Custom Line Navetta 30 - M/Y AT ONE

TECHNICAL CHARACTERISTICS

RCD / CE Category: B + F + Aa (Sound Em.)	Classifying Body: RINA S.P.A.
Main Generator: Kohler 35kW 50Hz Hours: 1450	2 nd Generator: Kohler 35kW 50Hz Hours: 1192
Fuel Tank: 14.500lt / 3.830gal Black Tank: 900lt / 238gal	Water Tank: 2.500lt / 660gal Grey Tank: 900lt / 238gal
Stabiliser(s): Seakeeper 40 (Gyro) Fins: 2x Sleiپner electro-hydraulic fins	Bow Thruster: Sleiپner 58hp Stern Thruster: Sleiپner 30hp
Water Purifier: PURO system Internet Coverage: 2x Starlink units	Material: GRP - Fiberglass External Hull Colour: White

YACHT DESCRIPTION

Interior Design: Ferretti Group Project Architect & Engineering Department

Exterior Design: Filippo Salvetti Design

Internal Furniture: The interiors of M/Y AT ONE are crafted to exceptionally high standards, showcasing a level of personalisation unmatched by any other Navetta 30. Her bespoke master cabin has been reimagined with an additional custom vanity desk, enhanced upholstery, redesigned shelving, and a refined marble-and-mosaic bathroom. Interior fit-outs were developed in collaboration with Dior, Chanel, Minotti, and other iconic brands, elevating every detail. Striped dark walnut wood adds depth, warmth, and timeless sophistication throughout the yacht.

LAYOUT

M/Y AT ONE features an elegant three-deck layout designed for comfort and privacy. The main deck hosts the spacious forward master suite, while the lower deck offers two VIP cabins and two additional guest cabins, all en-suite. Crew accommodation is optimized at the bow with three en-suite cabins ensuring smooth service and discretion. A main deck day head adds convenience for guests. Thoughtfully arranged, the layout maximizes space, flow, and luxury across every level.

BROKER COMMENT

M/Y AT ONE stands as the most customised and technically enhanced Navetta 30 on the market. The master cabin has been re-designed with premium materials unlike any other Navetta 30 delivered. She is MCA coded and fully charter-ready, she features major technical upgrades including Seakeeper 40, dual Starlink systems and advanced PURO water filtration. Upgraded bridge and crew spaces enhance operational efficiency. Following the completion of all warranty works at the shipyard over the Winter months, she will be better than new and available immediately for the 2026 summer season.

Disclaimer:

Brokers present the particulars of this Vessel in good faith; however, they cannot guarantee or warrant the accuracy of this information, nor do they provide any assurances regarding the Vessel's condition. Images of the Vessel may be sourced from a catalogue. This document shall not, under any circumstances, be deemed a contractual term.

2024 Custom Line Navetta 30 - M/Y AT ONE

SPECIFICATION

EQUIPMENT:

General:

Miele galley appliances upgrade
Miele Professional washer and dryer
Hydraulic 30HP stern thruster
Idrostop shaft seal system
Active carbon filter
Water softener
Idromar 500 l/h duplex watermaker
Automatic battery charger for generators
Removable hot/cold hand shower
Tropical air conditioning with UTA
Electric curtains on all decks
Decorative lighting under furniture
Sliding bed in starboard guest cabin
Decorative lighting strips
Additional wardrobe lighting
Extensive additional sockets and USB ports
BYOD integration
Additional fire extinguishers
Solas B life rafts (8+8 pax)
Adult and children's lifejackets

External:

Teak covering with black caulking on bow dinette, sun deck and forward areas
Underwater lights (10)
Carbon-fibre bimini tops on bow, forward deck and upper cockpit
Upgraded anchoring system with 16mm galvanised DIN766 chain (150m per side)
Exterior courtesy lights and dimmers
Inflatable fenders
Upgraded swivels and deck gear
Enlarged stern cleats with reinforced bases
Specialist, custom-manufactured towing line and bridle rig, paired with upgraded rear clears
Additional aft cleats on sponsons
Fireproof insulation in garage ceiling
Bespoke garage fire system integrated into the main system (certified)
Smoke detector in garage
Additional bow sofa covers
Original exterior cushions
White exterior side tables
Exterior bins

Internal:

Striped dark walnut interior wood
Glass handrails on stairs

Disclaimer:

Brokers present the particulars of this Vessel in good faith; however, they cannot guarantee or warrant the accuracy of this information, nor do they provide any assurances regarding the Vessel's condition. Images of the Vessel may be sourced from a catalogue. This document shall not, under any circumstances, be deemed a contractual term.

2024 Custom Line Navetta 30 - M/Y AT ONE

SPECIFICATION (continued):

Wallpaper in lower deck lobby and cabins
Ceramic floors and shower trays in all lower deck bathrooms
Mosaic finishes in bathrooms and day head
European Select Oak flooring on main and upper decks
Nabuk-upholstered cabin walls
Shoe box cabinet
Table decor cabinet
Brown and Orange plates
Cutlery
Raunard coffee mugs x8
Plates, bowls that came with the boat
Leather-upholstered night table and desk tops
Electrocromic TV lift in upper deck salon
Gym equipment
Techno gym
Leather upholstery upgrades in wheelhouse and master cabin
Customised rugs and cushions
Catherine Carnaby rugs x2
Additional shelves in upper deck salon furniture
Black additional cupboards in upper salon
Black storage boxes made for galley window and back shelf
Original white interior cushions
Original bed day covers
Original pillow cases
Original sheets
White towels
Crew bedding
Crew blue towels
Artwork on cabin walls

Technical:

Gyro stabilizer Seakeeper 40
FLIR night vision camera
Simrad AIS system
Additional Wi-Fi access points
Electrohydraulic garage ceiling system for jet ski
Super Premium Integrated Bridge
Microterm temperature sensor
Enhanced air extraction in lower deck bathrooms
Starlink cabling and antenna installation
Radar reflector installation
Puro water purification system
Hamann system
Electrohydraulic jet-ski launch system with saddles

Disclaimer:

Brokers present the particulars of this Vessel in good faith; however, they cannot guarantee or warrant the accuracy of this information, nor do they provide any assurances regarding the Vessel's condition. Images of the Vessel may be sourced from a catalogue. This document shall not, under any circumstances, be deemed a contractual term.

2024 Custom Line Navetta 30 - M/Y AT ONE

SPECIFICATION (continued):

Garage roller curtain with yacht name
Anchor ball

NAVIGATION:

Super Premium Integrated Bridge
Simrad Navionics XL9 chart map
Simrad IS42 multi-indicator
Naviop monitoring page for portholes and doors
Halo 6ft radar antenna
Class A VHF upgrade
Radio survey

AUDIO VISUAL:

All-in-one AV control with iPad
Domotic Area A AV package
Sonance premium external audio
Premium sound packages for internal areas
Samsung 55" master cabin TV
55" lift TV in upper deck salon
55" lift TV in main deck salon
Samsung Frame TVs in lower deck cabins
PlayStation/HDMI predisposition in guest cabin
iPad

DOMESTIC:

Professional icemaker in pantry
Additional icemaker in upper deck salon
Additional freezer installed in the garage
Drawer fridge on sun deck
Fresh-water washing outlet
Additional fridge in galley column
Miele combo microwave
Wine cooler installation
Upgraded table set, bowls and trays

TENDER & TOYS:

Tender Yamaha 15hp
4-5m Inflatable

Disclaimer:

Brokers present the particulars of this Vessel in good faith; however, they cannot guarantee or warrant the accuracy of this information, nor do they provide any assurances regarding the Vessel's condition. Images of the Vessel may be sourced from a catalogue. This document shall not, under any circumstances, be deemed a contractual term.

2024 Custom Line Navetta 30 - M/Y AT ONE

LAYOUT

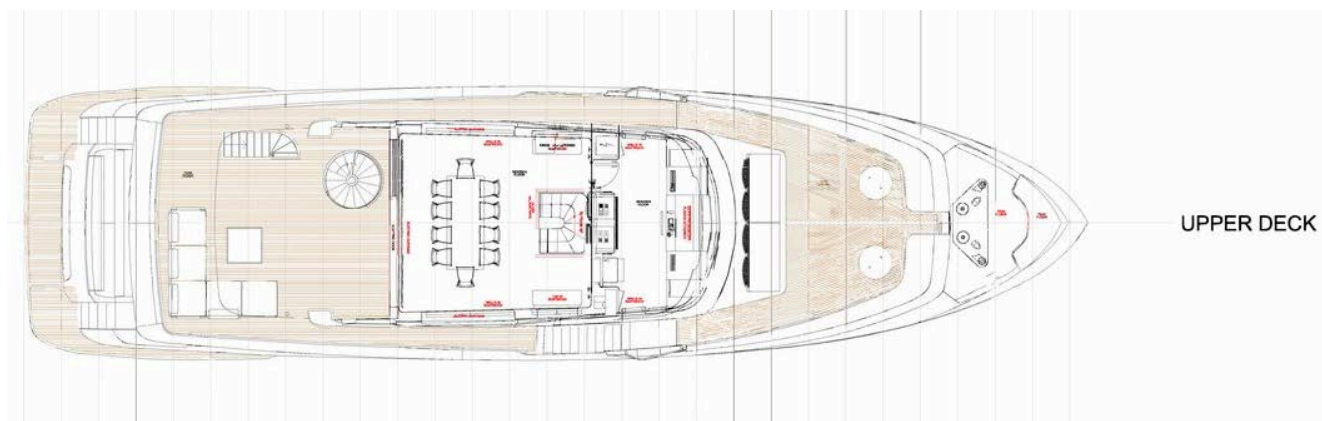
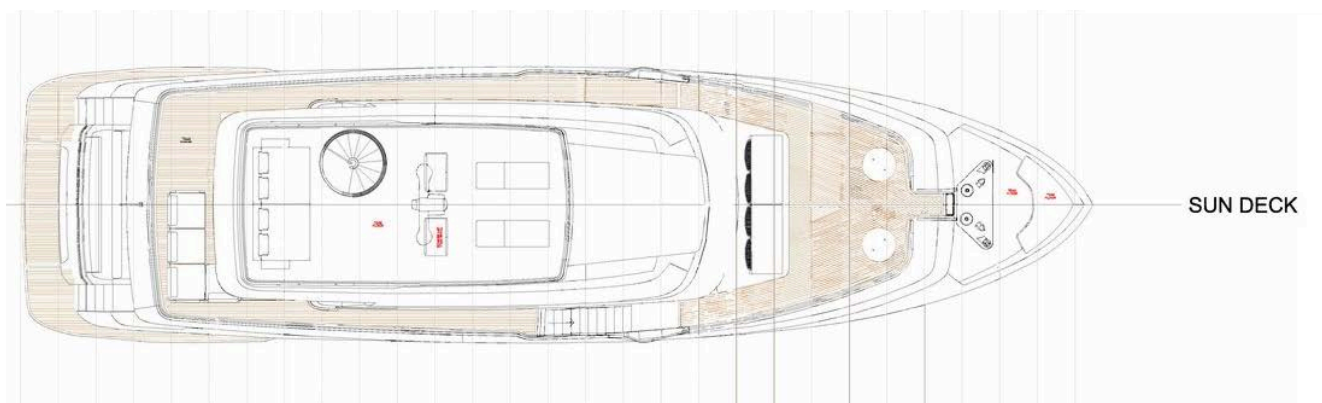

Disclaimer:

Brokers present the particulars of this Vessel in good faith; however, they cannot guarantee or warrant the accuracy of this information, nor do they provide any assurances regarding the Vessel's condition. Images of the Vessel may be sourced from a catalogue. This document shall not, under any circumstances, be deemed a contractual term.

2024 Custom Line Navetta 30 - M/Y AT ONE

LAYOUT:

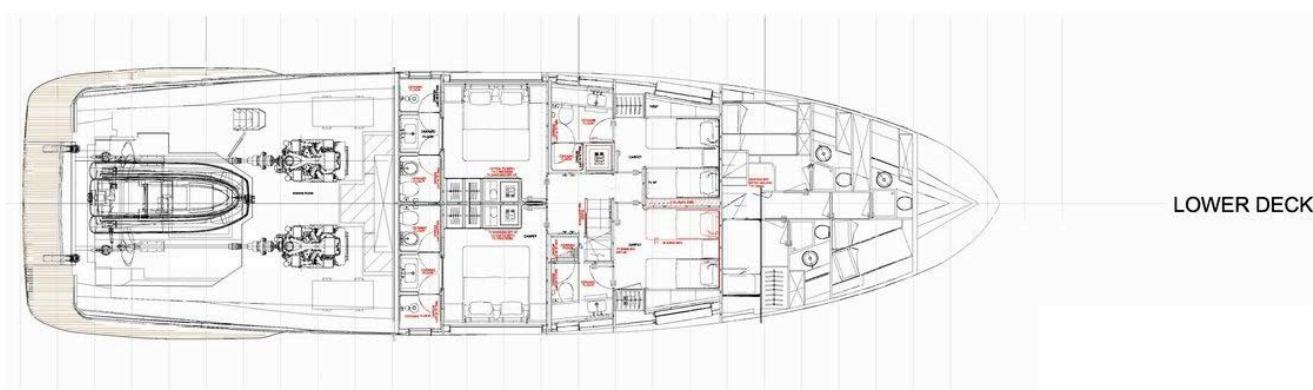

Disclaimer:

Brokers present the particulars of this Vessel in good faith; however, they cannot guarantee or warrant the accuracy of this information, nor do they provide any assurances regarding the Vessel's condition. Images of the Vessel may be sourced from a catalogue. This document shall not, under any circumstances, be deemed a contractual term.