

Hull number: 20 - year of built: 2021



## MAIN FEATURES

BUILDER	FERRETTI YACHTS	MODEL	920
HULL NUMBER	20	TYPE	Motor Yachts
HULL TYPE	Planing	BOAT NAME	Duru Beren
YEAR	2021	CONSTRUCTION MATERIAL	Fiberglass - VTR
LOA	28.49 [m] - 93.5 [ft]	BEAM	6.78 [m] - 22.2 [ft]
DRAFT	2.3 [m] - 7.6 [ft]	ENGINES	MTU 16V 2000 M86
CRUISING SPEED	24 [kn]	MAX SPEED	28 [kn]
N° GUEST CABIN	5	N° CREW CABIN	2
N. TOILETS	6	DISPLACEMENT	99 [t]
ON DISPLAY AT/IN	Istanbul	COUNTRY	Turkey
FLAG	Turkey	ASKING PRICE	6,600,000.00 [euro]
VAT STATUS	Not paid		

## Technical information

---

Engines hours	225
Trasmissions	Shaft Drive
Fuel tank	9000 lt
Water tank	1320 lt

---

## Description per area

---

### General description

M/Y DURU BEREN is a meticulously maintained Ferretti Yachts 920 with a well-designed 5-cabin layout, offering both luxury and practicality. In amazing condition and fully equipped, this yacht delivers exceptional performance and comfort. Its sleek profile is accentuated by unique detailing on the gunwale, which extends beyond the bulwarks and intersects the master cabin window, creating a striking visual effect. Despite her impressive 23.98-meter hull length, she can still be registered as a pleasure craft. M/Y DURU BEREN provides a refined setting for those seeking elegance and performance on the water .

---

## Optional list

---

### Optional list

#### NAVIGATION:

Full Simrad Navigation (Monitor 24")  
 Autoidentification System AIS Receiver Simrad Nais400  
 Transducer B765Lm  
 Simrad Autopilot: Op10 Control Keyboard  
 Multidata Display Simrad IS40  
 Radar Antenna HALO 6 Diff. from HALO 3  
 Radar Antenna Painted in Gray Colour  
 Searchlight Acr RCL 300  
 TVCC: External color camera, additional Cad. Fixed, on aft Deck corners Premium Internet Package USA  
 Empty Dome For Kvh Tv6 Usa  
 CCTV Switch to display more than 2 cameras

#### TECHNICAL EQUIPMENT:

Stabilizing Fins Zero Speed  
 Converter Asea Ac-24Kva-O Out 120V 60Hz  
 Additional Isolation Engine Room Bulkhead  
 Additional Lights in Engine Room  
 3Kg Gelcoat  
 Stern Thruster Hydraulic 40 Hp  
 Kahlenberg Horn And Compressor Diff.  
 Smoke Separator for Gen. (22,5-27Kw) 3" Water  
 Searecovery Aquamatic 1400-2 Water Maker  
 Shore Fresh Water Intake  
 Tender Launching System

#### INTERIOR:

Dining Table Diff. from Std.  
 Assorted Decorative Cushions in the Cabins  
 Sofa Main Deck Salon Diff.  
 Armchair Diff. from Std. in Salon  
 Coffee Table Diff.  
 Waste Mincer in Galley Sink 230V  
 Curtains Diff. from Std.  
 Cabin Upholstery Diff.  
 Gaggenau Grill on the Flybridge Diff.  
 Teppan Yaki Hob  
 Molteni Bed Linen  
 Parquet in Master Bathroom Diff.  
 Parquet in Main Helm Diff.  
 Pilot Seat in Leather Diff.  
 Carpet in Master Cabin Diff. from Std.  
 Carpet Lower Deck Diff.  
 Wooden Floor in Salon and Galley Diff.  
 Electric Sliding Salon Door Diff.  
 Control Station in the Cockpit Fixed with Cover  
 Table's Top Finishing Diff. from Std. (Bow Dinette)  
 Dining Chairs Diff. from Std.  
 Master Bathroom Sink Diff.  
 Shower in Owner Bathroom in Mosaic  
 Shower Ceiling Diff.  
 Lighting for Stairs Towards Cabins  
 Minibar Fridge in Lower Deck  
 Strip Led Under Beds (All 5 Cabins)  
 TV 55" USA in Salon and Master Cabin  
 TV 48" USA in VIP Cabin and Guest Cabin SX  
 TV 28" USA in Right Guest Cabin and Guest Cabin RX  
 TV: Electric Raising Device for TV 40"/65"  
 One Touch Up/Down Electric Curtains  
 Electrical Blinders in the 4 Cabins  
 Led Lights Under Steps in Master Cabin  
 Dimmer Lights  
 Sirius System

---

EXTERIOR:

Protection Covers  
Additional Lights on Fly  
Sun Bed on Fly  
Teak On Fly with Gray Caulking  
Teak Floor with Gray Caulking Diff.  
Canvas Package  
Manual Bimini at Bow with 4 Carbon Poles  
Led Lights at Bow  
Lighting in Spoiler Stairs  
Lights Underwater Light Watertight - Couple  
Lights Underwater Light  
Watertight Lights for Staircase from Cockpit to Fly  
Teak Table in the Cockpit in Sealed Teak Painted Wood Diff. Canopy with 4 Carbon Poles  
Anti-Skid in Bridge

APPLIANCES:

"Miele" Galley Appliances Diff.  
Ice-Maker Raritan Sul Fly  
Raritan Ice-Maker USA Diff.

OTHER:

External Upholstery Diff. from Std.  
Waterline Stripe Diff.  
Table in the Cockpit in Sealed Teak Painted Wood Diff. Corridor Wall Upholstered

---

**Disclaimer**

BROKERS offer the details of this vessel in good faith but cannot guarantee or warrant the accuracy of this information nor warrant the condition of the vessel. Pictures of the vessel may be taken from the catalogue. This document does not represent in any case a contractual term.

---

## Layout

---

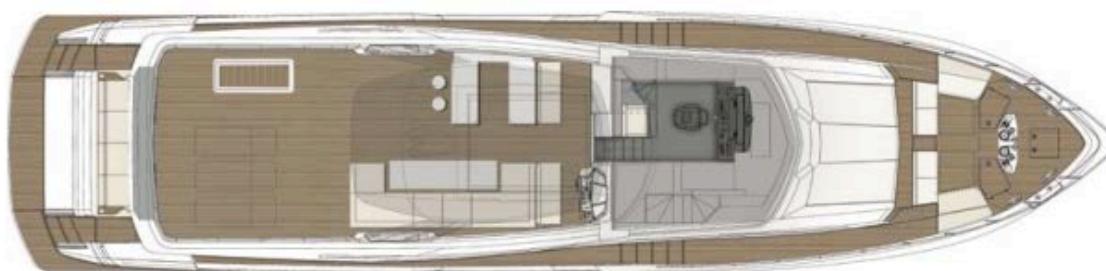



5 cabins + 5 bathrooms

